

## Planetary Mixers

### Planetary Mixer, 80 lt. - Electronic with Hub

ITEM # \_\_\_\_\_

MODEL # \_\_\_\_\_

NAME # \_\_\_\_\_

SIS # \_\_\_\_\_

AIA # \_\_\_\_\_

**600290 (XBE80AB3)**

80 lt Planetary Mixer, bowl detection device and SOLID BPA free safety screen, with electronic speed variation, timer, motorized bowl movement and bowl lighting. Equipped with stainless steel spiral hook, paddle, whisk and bowl trolley. H type accessory

### Short Form Specification

#### Item No.

Floor model, suitable for all kneading, blending and whipping operations. Body in non-corrosive material with 18/8 (AISI 302) 80 litre stainless steel bowl and bowl trolley. Powerful asynchronous motor (4000 W) with electronic speed variator (10 speed levels from 20 to 180 rpm). Motor and mechanism are protected against overloading. Heavy duty safety screen. Removable and dismantled solid safety screen - made of a bisphenol-A free (BPA) copolyester. Control panel with timer and bowl lighting. Geared motor drive system to raise and lower the bowl. Bowl detection device allows the mixer to switch on only when the bowl and the safety screen are properly installed and positioned together. Equipped with accessory drive hub type H (accessories are not included). Supplied with 3 tools: stainless steel spiral kneading hook, cast aluminium paddle and stainless steel wire whisk.

### Main Features

- Professional beater mixer for kneading, mixing and whisking all types of food products.
- Electronic speed variator.
- Maximum capacity (flour, with 60% of hydration) 25 kg, suitable for 400-800 meals per service.
- Waterproof control panel with timer and speed setting knobs.
- Wire safety screen fitted with a removable chute to add products while working, thus ensuring operator safety.
- Geared motor drive system activates the raising and lowering of the bowl and bowl lighting.
- Safety device will automatically stop the machine if the screen is lifted.
- Delivered with:
  - Stainless steel spiral kneading hook, Cast aluminum paddle, 302 AISI stainless steel whisk, mixing bowl for 80 lt and bowl trolley
  - Accessory drive hub (accessories are not included)
- Solid BPA-free safety screen, covering the stainless steel wire one, limits the flour and unsafe dust particles when used in bakery and pastry preparation.
- Bowl detection device allows the mixer to switch on only when the bowl and the solid safety screen are properly installed and positioned together.

### Construction

- Body in non-corrosive material.
- Sturdy construction with mechanically welded strong metal frame.
- 302 AISI Stainless steel bowl - 80 lt. capacity.
- Asynchronous motor with high start-up torque.
- 10 speeds from 20 to 180 rpm (planetary movement) to adjust to the selected tool and the mixture hardness.
- Water protected planetary system (IP55 electrical controls, IP23 overall machine).
- Overload protected planetary system and motor.
- Height adjustable feet.
- Power: 4000 watts.
- Adjustable feet for perfect stability.

### Included Accessories

- 1 of Bowl 80 lt mixer PNC 650130
- 1 of Stainless steel (AISI 303) Spiral Hook for 80 lt planetary mixers PNC 653133
- 1 of Whisk 80 lt PNC 653134
- 1 of Paddle 80 lt PNC 653135
- 1 of Bowl trolley for 40/60/80 lt planetary mixers PNC 653585

### Optional Accessories

- Bowl 80 lt mixer PNC 650130

APPROVAL: \_\_\_\_\_

- 60 lt reduction kit (bowl, spiral hook, paddle, whisk) for 80 lt planetary mixers PNC 650131
- Stainless steel (AISI 303) Spiral Hook for 80 lt planetary mixers PNC 653133
- Whisk 80 lt PNC 653134
- Paddle 80 lt PNC 653135
- Puree strainer for H hub supplied with 1 screw and 3 grids of 1.5, 3 and 6 mm PNC 653187
- Vegetable cutter, attachment type H, disconnectable drive, for planetary mixers PNC 653225
- Bowl scraper 80 lt PNC 653443
- Bowl trolley for 40/60/80 lt planetary mixers PNC 653585
- Aluminium external support for 82 mm meat mincer (includes tray and pusher) - H HUB - To be combined with a meat mincer kit PNC 653724
- Stainless steel meat mincer kit 82 mm - Enterprise cut, includes blade (3 discs, diam. 4.5 - 6 and 8 mm) PNC 653725
- Aluminium meat mincer kit 82 mm - Enterprise cut, includes blade (3 discs, diam. 4.5 - 6 and 8 mm) PNC 653726
- Stainless steel meat mincer kit 82 mm - 1/2 Unger cut, includes blade (4 discs, diam. 0, 3 - 4.5 and 8 mm) PNC 653727

Front

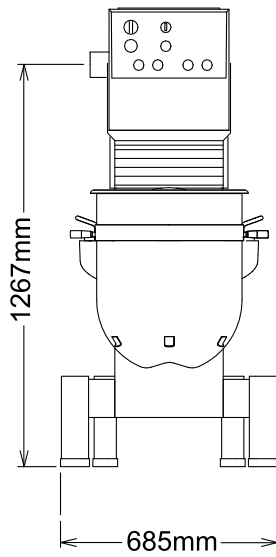

Side

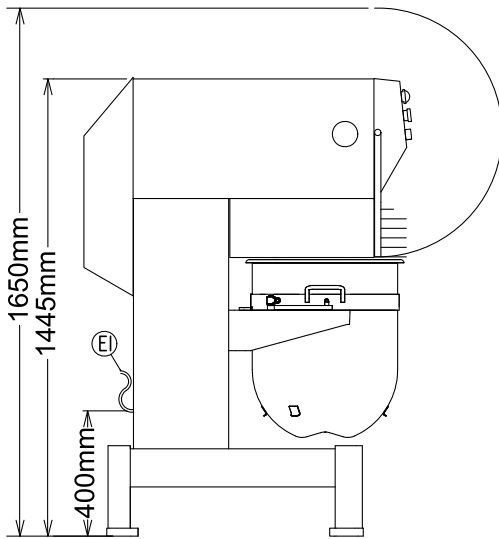

EI = Electrical inlet (power)

Top

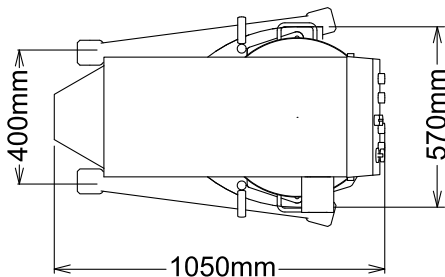
**Electric**

Supply voltage: 380-440 V/3N ph/50/60 Hz  
 Electrical power max.: 4 kW

**Capacity:**

Performance (up to): 25 kg/Cycle  
 Capacity: 80 litres

**Key Information:**

External dimensions, Width: 685 mm  
 External dimensions, Depth: 1050 mm  
 External dimensions, Height: 1445 mm  
 Shipping weight: 345 kg  
 Cold water paste: 25 kg with Spiral hook  
 Egg whites: 120 with Whisk